

### STEP #1

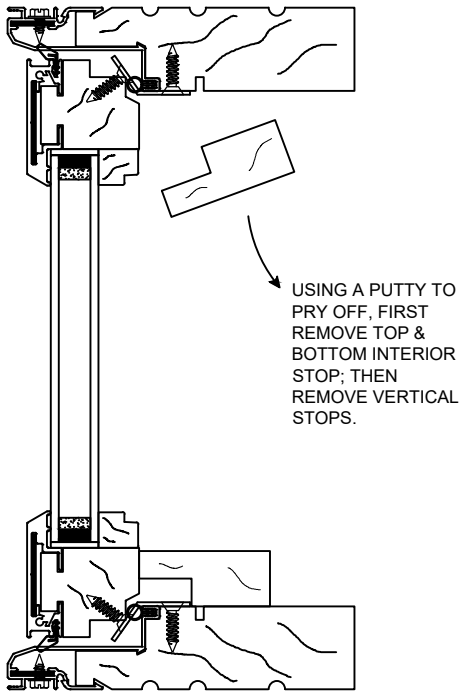

### STEP #2

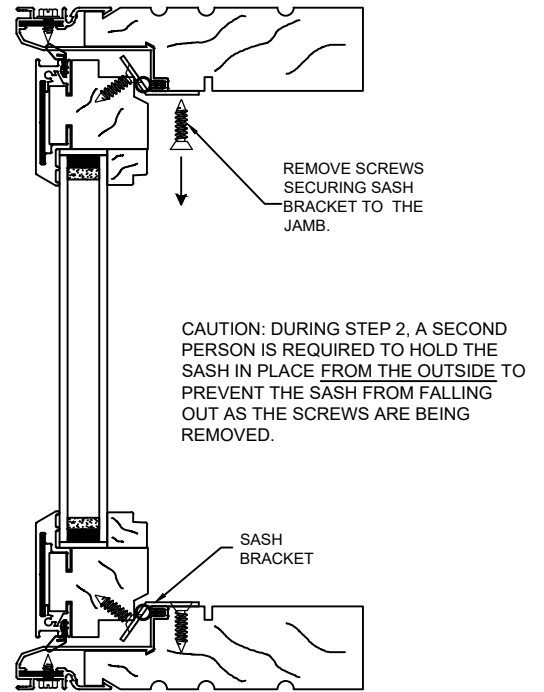

### STEP #3

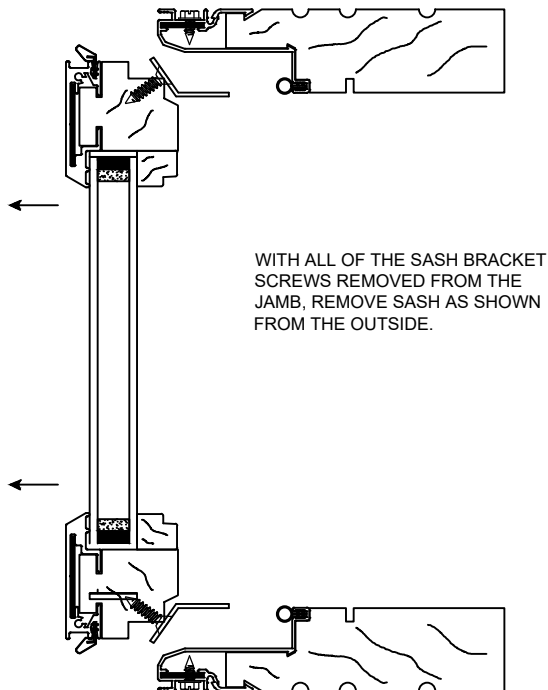

#### NOTE:

AFTER OLD SASH HAS BEEN REMOVED, REMOVE THE SASH BRACKETS AND RE-ATTACH THEM TO THE NEW SASH IN THE SAME LOCATIONS. CENTER NEW SASH IN POSITION ON THE OUTSIDE WHILE SOMEONE FROM THE INSIDE, SCREWS THE BRACKETS INTO THE JAMB. REPLACE INTERIOR STOPS. (TRIM PIECES HAVE CUT OUTS ON THE REVERSE SIDE TO ACCOMODATE THE SASH BRACKETS)

THE INFORMATION CONTAINED IN THIS DRAWING IS THE SOLE PROPERTY OF TRIMLINE WINDOWS INC. ANY REPRODUCTION IN PART OR AS A WHOLE WITHOUT THE WRITTEN PERMISSION OF TRIMLINE WINDOWS INC. IS PROHIBITED.

**TRIMLINE**  
**WOOD WINDOWS**  
 50 Louise Drive  
 Ivyland, Pennsylvania, 18974

#### DESCRIPTION:

**CP4000 SASH REMOVAL**

#### CUSTOMER:

SIZE: A	SCALE: N.T.S.	SHEET: 1 OF 1
DRAWN BY: J.R.S.	DATE: 6-4-2018	DWG #: